

Useful Tips



- If you decide to heat the liquid in the bottle, make sure the COLLAR is loose. Better still, remove the collar altogether as shown above. This is the best way to avoid overheating the liquid.
- To ensure correct function of the vent make sure:
There is no gap between the white vent cover and the vent.
The slit is open before feeding.
The collar is screwed firmly, not too tight.
- When travelling, seal the teat with the cap to protect against leakage.

The following WARNINGS are for your child's safety and health

- Keep all components out of the reach of children when not in use.
- Microwave heating of liquid is not recommended as this can cause hot spots.
- Always check the food temperature before feeding.
- Always use this product with adult supervision. Do not leave glass bottles within baby's reach – this may be dangerous to him/her.
- Never use a feeding teat as a soother.
- Continuous and prolonged sucking of fluids will cause tooth decay. This occurs in infants even when non-sweetened fluids are used. This can happen if your child is allowed to use the bottle for long periods through the day and particularly at night when saliva is reduced.
- Do not put bottles with liquid inside them into suitcases or handbags. Damage to the bottle will cause leakage.

Teats

- We recommend that you only use Bfree Teats.
- The bottles are supplied with the following teats:

Stage 1: 160ml, 260ml

Stage 2: 300ml

Additional Bfree Teats:

Stage 2 MEDIUM FLOW, 3 months +

Stage 3 FAST FLOW, 6 months +

Also operates as a Medium flow teat with some thicker types of formula.

Stage 4 THICK LIQUIDS, 6 months +

Operates as a Fast flow for all types of liquid including thicker types of formula and cereal additives.

VARIABLE FLOW 3 months +

Combines stages 2, 3 and 4 in one teat.

These flow rates are averages. Hungrier babies can move faster through the teat speeds shown above.

- Inspect the teat before each use and pull it in all directions. Throw away the teat at the first sign of damage or wear and tear (such as from biting).
- We recommend that you replace the teats every 6–8 weeks for hygiene purposes.
- Do not leave teats in sterilizing solution longer than recommended nor in direct sunlight or heat. These conditions may weaken the teat.
- Latex teats: these teats contain natural rubber latex which can cause allergies.
- Do not use a dishwasher to clean teats.

Cleaning

- It is very important to clean the bottle and all the components after every feeding.
- Do not use solvents or abrasive cleaning agents.
- Do not place bottles on work surfaces that have been cleaned with anti bacterial detergents. Excessive concentrations may cause cracks in the bottle.
- All parts are Dishwasher safe, we recommend placing the parts on the top shelf of the dishwasher and away from the heating source.
- Do not place the parts in detergent solvents for a long time period, this may weaken the plastic and silicone.

Bfree SIPPI CUPS

Our unique cup uses the same revolutionary venting design. This will ensure your baby can make a smooth transition from a bottle to a drinking cup.



Bfree TWISTER Brush Set

These unique brushes are ideal for cleaning your Bfree bottles and teats.

- The BOTTLE BRUSH rotates easily for really effective cleaning.



- The TEAT BRUSH has a special sponge which allows you to clean the inside of the teat.



Bfree®



instruction leaflet for glass & plastic Bfree bottles



Caution: Sudden temperature changes can cause glass bottles to crack or break. Before each use, inspect bottles for sharp edges or glass fragments inside. Do not use bottles if there are any cracks on or glass fragments in the bottle.

Please follow the steps carefully

1. Bottle parts:

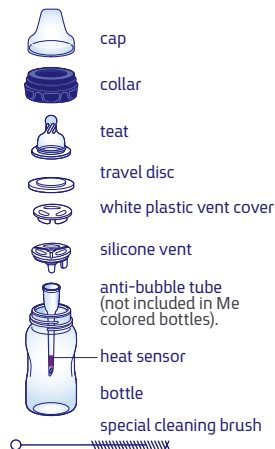

2. Before first use, wash all parts in hot, soapy water and then sterilize in boiling water for 5 minutes. Alternatively, when using a sterilizer please follow manufacturer's instructions.



3. Make sure hands are clean prior to assembly of any bottle parts.



4. Pour the breast milk or formula into the bottle and heat to 37°C, making sure the formula is mixed according to the manufacturer's instructions.



5. Push the white vent cover onto the silicone vent as shown.
Make sure:
- there is no gap between the white vent cover and the vent.
 - the slit is open before feeding.

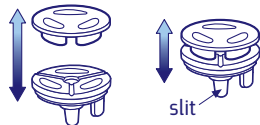

6. Push the vent into the top of the anti-bubble tube.
(Anti-bubble tube not included in Me colored bottles).

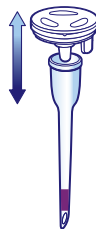

7. Push the vent firmly into the top of the bottle.



8. Pull the teat through the collar and screw the collar firmly onto the bottle.
(Do not tighten excessively to allow proper ventilation)



9. If you decide to mix the formula inside the bottle you can shake it as shown, in a twisting action.



10. Before feeding your baby, check the heat sensor device. If it is purple it is safe to feed. If it has changed to pink, the feed is too hot. It will change from purple to pink if the feed is heated above the recommended level of 37°C.

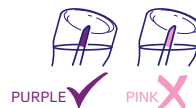

Do not leave heat sensor in direct sunlight when not in use.

The anti-bubble tube prevents air mixing with the milk to produce bubbles that cause colic in the baby. The anti-bubble tube can be removed when the baby is 3-6 months old or when colic is no longer a problem.

11. As an extra precaution, we recommend that you also check the temperature of the feed by shaking a few drops onto the back of your hand before feeding.



12. Feed your baby by holding him/her in the correct position as shown.



13. After feeding, disassemble all the parts and wash in hot, soapy water. For the bottle and teat we recommend you use the Bfree TWISTER Brush Set.



14. Use the special brush provided to clean the inside of the anti-bubble tube as shown (not included in Me colored bottles).
Do not use it to clean the silicone vent so as not to puncture it.

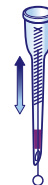

15. After the bottle and all parts have been carefully cleaned you may repeat step 2 or place all parts in a cool, dry place for safekeeping.

